

Rim Owners Manual

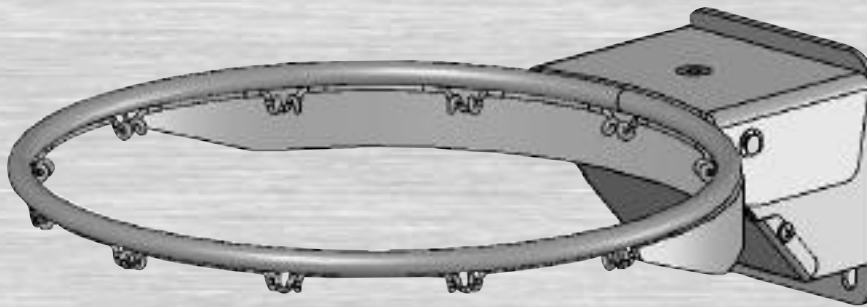

Model Number:



! WARNING!

**READ AND UNDERSTAND
OPERATOR'S MANUAL
BEFORE USING THIS UNIT.**

**FAILURE TO FOLLOW
OPERATING INSTRUCTIONS
COULD RESULT IN INJURY
OR DAMAGE TO PROPERTY.**

Toll-Free Customer Service Number for U.S.: 1-800-558-5234
Internet Address: www.spalding.com

Toll-Free Customer Service Number for Australia: 1300 367 582
Internet-Address: www.spalding.com.au

REQUIRED TOOLS AND MATERIALS:



- (2) Stepladders 8 ft. (2.4 m)



- (1) Allen Wrench (5/16")
- (1) Allen Wrench (3/16")

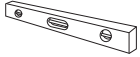

- (1) Carpenter's Level

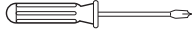

- (1) Phillips-Head Screwdriver



- (2 each) 3/4" & 9/16" Wrenches and/or Socket Wrenches and Sockets



(Deep-Well Sockets are Recommended).



3/4"



9/16"

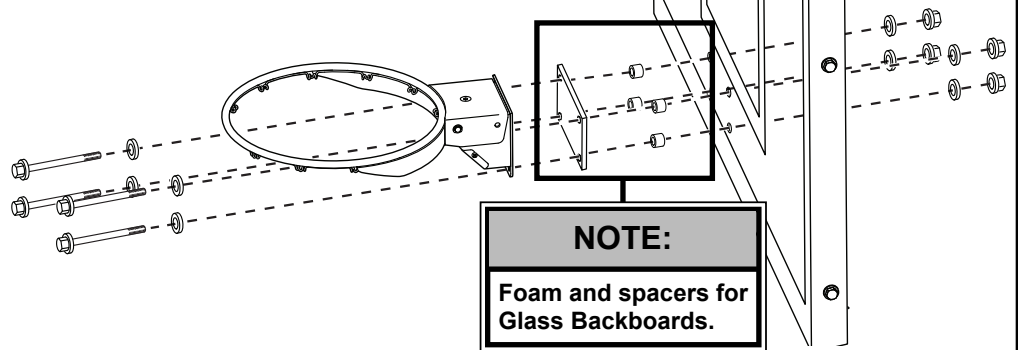
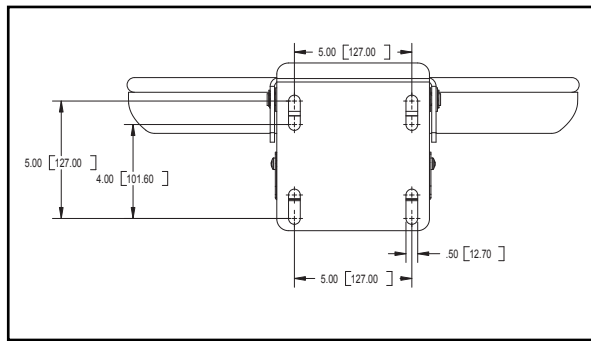

NOTE:

Foam and spacers for Glass Backboards.

TO LEVEL RIM

- Remove the rim cover from the rim.
- Make adjustments as shown below.

Tightening the nut which preloads the spring increases the rim's resistance to movement - the more the preload, the more force will be required to move the rim downward.

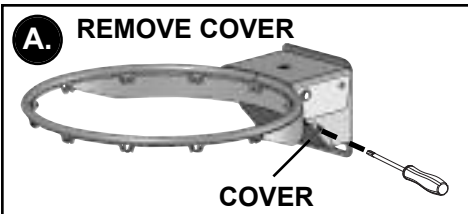

B.

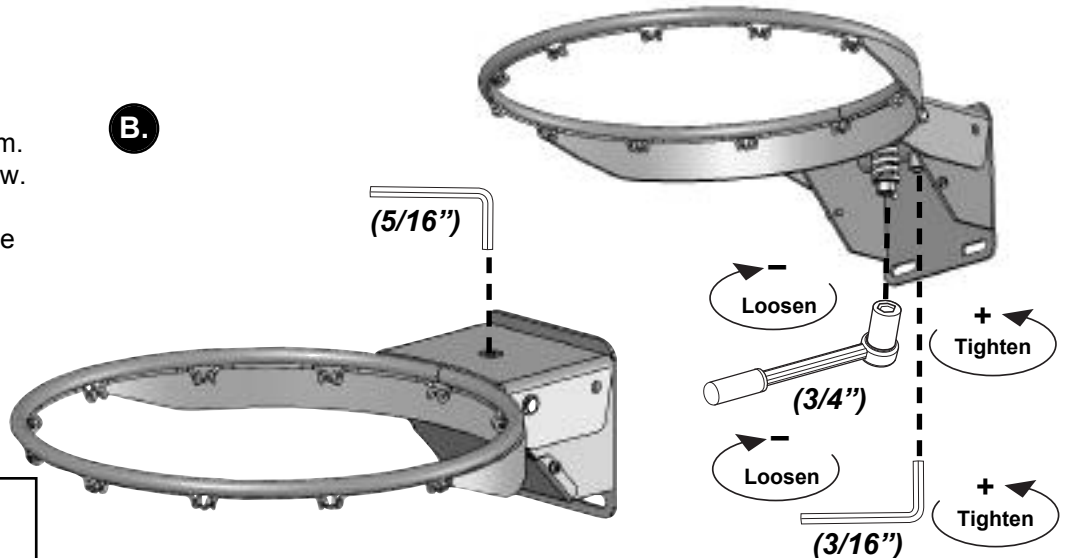

Tightening set screw preloads the spring and ball assembly increasing resistance in the positive locking mechanism.

INSTALL NET

1.

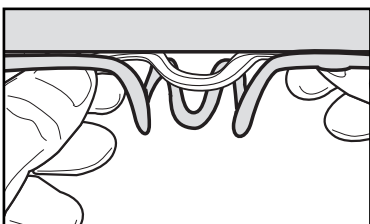

2.

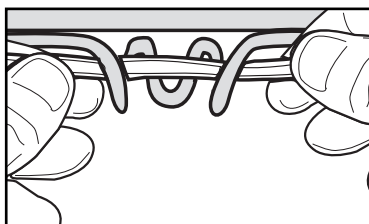

3.

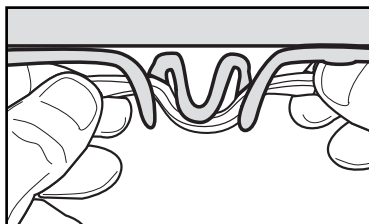

4.

